



REPLY TO  
ATTENTION OF

DEPARTMENT OF THE ARMY  
JACKSONVILLE DISTRICT CORPS OF ENGINEERS  
GAINESVILLE REGULATORY OFFICE  
2831 NW 41<sup>ST</sup> STREET, SUITE K  
GAINESVILLE, FLORIDA 32606

Pensacola Section  
SAJ-2009-01654 (NW-SEG)

June 2, 2009

Charles Fagan  
Hernando Parks and Recreation  
20 North Main Street, RM 260  
Brooksville, FL 34601

2009 JUN -4 11:11:18

Dear Mr. Fagan:

Your application for a Department of the Army permit has been assigned number SAJ-2009-01654. A review of the information and drawings provided shows the proposed work is the demolition of an existing 21-foot wide by 43-foot long boat ramp and the construction of a new 16-foot wide by 45-foot long boatramp. Dredge material would be placed in an upland containment cell located onsite. The containment cell would have dimensions of 12-foot wide by 45-feet long. The containment cell would be surrounded by two entrenched and staked silt fences spaced three feet apart. The project is located at 6401 Shoal Line Blvd, in Section 6, Township 23 South, Range 17 East, Town of Hernando Beach, Hernando County, Florida.

Your project, as depicted on the enclosed drawings, is authorized by **Nationwide Permit (NWP) Number 36**. In addition, project specific conditions have been enclosed. This verification is valid until June 2, 2011. Please access the U.S. Army Corps of Engineers' (Corps) Jacksonville District's Regulatory web to access web links to view the Final Nationwide Permits, Federal Register Vol. 72, dated March 12, 2007, the Corrections to the Final Nationwide Permits, Federal Register 72, May 8, 2007, and the List of Regional Conditions. Our website address is as follows:

**[http://www.saj.usace.army.mil/Divisions/Regulatory/permitting\\_types\\_NWP.htm](http://www.saj.usace.army.mil/Divisions/Regulatory/permitting_types_NWP.htm)**

These files contain the description of the Nationwide Permit authorization, the Nationwide Permit general conditions, and the regional conditions, which apply specifically to this verification for NWP. Additionally, enclosed is a list of the six General Conditions, which apply to all Department of the Army authorizations. You must comply with all of the special and

general conditions and any project specific condition of this authorization or you may be subject to enforcement action. In the event you have not completed construction of your project within the specified time limit, a separate application or re-verification may be required.

The following special conditions are included with this verification:

WE HAVE NO EVIDENCE THAT A STATE PERMIT HAS BEEN ISSUED FOR THE WORK, AND NO WORK MAY BEGIN UNTIL THEIR REQUIREMENTS ARE MET.

1. **Reporting Address:** All reports, documentation and correspondence required by the conditions of this permit shall be submitted to the following address: U.S. Army Corps of Engineers, Regulatory Division, Enforcement Section, P.O. Box 4970, Jacksonville, FL 32207. The Permittee shall reference this permit number, SAJ-2009-00633-SEG, on all submittals..

2. **Self-Certification:** Within 60 days of completion of the authorized work or at the expiration of the construction window of this permit, whichever occurs first, the Permittee shall complete the attached "Self-Certification Statement of Compliance" form (Attachment 1) and submit to the Corps. In the event that the completed work deviates, in any manner, from the authorized work, the Permittee shall describe, on the Self-Certification Form, the deviations between the work authorized by the permit and the work as constructed. Please note that the description of any deviations on the Self-Certification Form does not constitute approval of any deviations by the Corps.

3. **Regulatory Agency Changes:** Should any other regulatory agency require changes to the work authorized or obligated by this permit, the Permittee is advised that a modification to this permit instrument is required prior to initiation of those changes. It is the Permittee's responsibility to request a modification of this permit from the Gainesville Regulatory Office.

4. **Historic Properties:** No structure or work shall adversely affect or disturb properties listed in the National Register of Historic Places or those eligible for inclusion in the National Register. Prior to the start of work, the Permittee or other party on the Permittee's behalf, shall conduct a search

in the National Register Information System (NRIS). Information can be found at; <http://www.cr.nps.gov/nr/research/nris.htm>. Information on properties eligible for inclusion in the National Register can be identified by contacting the Florida Master File Office by email at [fmsfile@dos.state.fl.us](mailto:fmsfile@dos.state.fl.us) or by telephone at 850-245-6440.

If unexpected cultural resources are encountered at any time within the project area that was not the subject of a previous cultural resource assessment survey, work should cease in the immediate vicinity of such discoveries. The permittee, or other party, should notify the SHPO immediately, as well as the appropriate Army Corps of Engineers office. After such notifications, project activities should not resume without verbal and/or written authorization from the SHPO.

If unmarked human remains are encountered, all work shall stop immediately, and the proper authorities notified in accordance with Section 872.05, Florida Statutes, unless on Federal lands. After such notifications, project activities on non-Federal lands shall not resume without verbal and/or written authorization from the Florida State Archaeologist for finds under his or her jurisdiction.

5. **Manatee Conditions:** The Permittee shall comply with the "Standard Manatee Conditions for In-Water Work - July 2005" provided in Attachment 1 of this permit.

6. **Assurance of Navigation and Maintenance:** The Permittee understands and agrees that, if future operations by the United States require the removal, relocation, or other alteration, of the structures or work herein authorized, or if in the opinion of the Secretary of the Army or his authorized representative, said structure or work shall cause unreasonable obstruction to the free navigation of the navigable waters, the Permittee will be required, upon due notice from the Corps of Engineers, to remove, relocate, or alter the structural work or obstructions caused thereby, without expense to the United States. No claim shall be made against the United States on account of any such removal or alteration.

7. **Turbidity Barriers:** Prior to the initiation of any of the work authorized by this permit the Permittee shall install floating turbidity barriers with weighted skirts that extend to within 1 foot of the bottom around all work areas that are in, or

adjacent to, surface waters. The turbidity barriers shall remain in place and be maintained until the authorized work has been completed and all erodible materials have been stabilized.

8. **Erosion Control:** Prior to the initiation of any work authorized by this permit, the Permittee shall install erosion control measures along the perimeter of all work areas to prevent the displacement of fill material outside the work area. Immediately after completion of the final grading of the land surface, all slopes, land surfaces, and filled areas shall be stabilized using sod, degradable mats, barriers, or a combination of similar stabilizing materials to prevent erosion. The erosion control measures shall remain in place and be maintained until all authorized work has been completed and the site has been stabilized.

9. **Fill Material:** The Permittee shall use only clean fill material for this project. The fill material shall be free from items such as trash, debris, automotive parts, asphalt, construction materials, concrete block with exposed reinforcement bars, and soils contaminated with any toxic substance, in toxic amounts in accordance with Section 307 of the Clean Water Act.

This letter does not give absolute Federal authority to perform the work as specified on your application. The proposed work may be subject to local building restrictions mandated by the National Flood Insurance Program. You should contact your local office that issues building permits to determine if your site is located in a flood-prone area, and if you must comply with the local building requirements mandated by the National Flood Insurance Program.

If you are unable to access the internet or require a hardcopy of any of the conditions, limitations, or expiration date for the above referenced NWP, please contact Shaun Gallagher by telephone at 352-264-7672.

Thank you for your cooperation with our regulatory program. The Corps Jacksonville District Regulatory Division is committed to improving service to our customers. We strive to perform our duty in a friendly and timely manner while working to preserve our environment. We invite you to take a few minutes to visit the following link and complete our automated Customer Service

Survey: <http://regulatory.usacesurvey.com/>. Your input is appreciated - favorable or otherwise.

Sincerely,

A handwritten signature in black ink that reads "Shaun Gallagher". The signature is written in a cursive, flowing style.

Shaun Gallagher  
Project Manager

Enclosures:

General Conditions  
Self Certification of Compliance  
Permit Transfer Form  
Project Plans

bcc:  
CESAJ-RD-PE

GENERAL CONDITIONS  
33 CFR PART 320-330

PUBLISHED FEDERAL REGISTER DATED 13 NOVEMBER 1986

1. The time limit for completing the work authorized ends on **date identified in the letter**. If you find that you need more time to complete the authorized activity, submit your request for a time extension to this office for consideration at least one month before the above date is reached.
2. You must maintain the activity authorized by this permit in good condition and in conformance with the terms and conditions of this permit. You are not relieved of this requirement if you abandon the permitted activity, although you may make a good faith transfer to a third party in compliance with General Condition 4 below. Should you wish to cease to maintain the authorized activity or should you desire to abandon it without a good faith transfer, you must obtain a modification of this permit from this office, which may require restoration of the area.
3. If you discover any previously unknown historic or archeological remains while accomplishing the activity authorized by this permit, you must immediately notify this office of what you have found. We will initiate the Federal and state coordination required to determine if the remains warrant a recovery effort of if the site is eligible for listing in the National Register of Historic Places.
4. If you sell the property associated with this permit you must obtain the signature of the new owner in the space provided and forward a copy of the permit to this office to validate the transfer of this authorization.
5. If a conditioned water quality certification has been issued for your project, you must comply with the conditions specified in the certification as special conditions to this permit. For your convenience, a copy of the certification is attached if it contains such conditions.
6. You must allow a representative from this office to inspect the authorized activity at any time deemed necessary to ensure that it is being or has been accomplished in accordance with the terms and conditions of your permit.

**SELF-CERTIFICATION STATEMENT OF COMPLIANCE**

**Permit Number: NW-36**

**Application Number: SAJ-2009-01654**

Permittee's Name & Address (please print or type): \_\_\_\_\_

\_\_\_\_\_

\_\_\_\_\_

Telephone Number: \_\_\_\_\_

Location of the Work: \_\_\_\_\_

\_\_\_\_\_

Date Work Started: \_\_\_\_\_ Date Work Completed: \_\_\_\_\_

Description of the Work (e.g., bank stabilization, residential or commercial filling, docks, dredging, etc.): \_\_\_\_\_

\_\_\_\_\_

\_\_\_\_\_

Acreage or Square Feet of Impacts to Waters of the United States:

\_\_\_\_\_

Describe Mitigation completed (if applicable): \_\_\_\_\_

\_\_\_\_\_

\_\_\_\_\_

Describe any Deviations from Permit (attach drawing(s) depicting the deviations): \_\_\_\_\_

\_\_\_\_\_

\_\_\_\_\_

\*\*\*\*\*

I certify that all work, and mitigation (if applicable) was done in accordance with the limitations and conditions as described in the permit. Any deviations as described above are depicted on the attached drawing(s).

\_\_\_\_\_  
Signature of Permittee

\_\_\_\_\_  
Date

DEPARTMENT OF THE ARMY PERMIT TRANSFER REQUEST

PERMIT NUMBER: \_\_\_\_\_

When the structures or work authorized by this permit are still in existence at the time the property is transferred, the terms and conditions of this permit will continue to be binding on the new owner(s) of the property. Although the construction period for works authorized by Department of the Army permits is finite, the permit itself, with its limitations, does not expire.

To validate the transfer of this permit and the associated responsibilities associated with compliance with its terms and conditions, have the transferee sign and date below and mail to the U.S. Army Corps of Engineers, Enforcement Section, Post Office Box 4970, Jacksonville, FL 32232-0019.

\_\_\_\_\_  
(TRANSFEREE-SIGNATURE)

\_\_\_\_\_  
(SUBDIVISION)

\_\_\_\_\_  
(DATE)

\_\_\_\_\_  
(LOT)      (BLOCK)

\_\_\_\_\_  
(NAME-PRINTED)

\_\_\_\_\_  
(STREET ADDRESS)

\_\_\_\_\_  
(MAILING ADDRESS)

\_\_\_\_\_  
(CITY, STATE, ZIP CODE)

## STANDARD MANATEE CONDITIONS FOR IN-WATER WORK

July 2005

The permittee shall comply with the following conditions intended to protect manatees from direct project effects:

- a. All personnel associated with the project shall be instructed about the presence of manatees and manatee speed zones, and the need to avoid collisions with and injury to manatees. The permittee shall advise all construction personnel that there are civil and criminal penalties for harming, harassing, or killing manatees which are protected under the Marine Mammal Protection Act, the Endangered Species Act, and the Florida Manatee Sanctuary Act.
- b. All vessels associated with the construction project shall operate at "Idle Speed/No Wake" at all times while in the immediate area and while in water where the draft of the vessel provides less than a four-foot clearance from the bottom. All vessels will follow routes of deep water whenever possible.
- c. Siltation or turbidity barriers shall be made of material in which manatees cannot become entangled, shall be properly secured, and shall be regularly monitored to avoid manatee entanglement or entrapment. Barriers must not impede manatee movement.
- d. All on-site project personnel are responsible for observing water-related activities for the presence of manatee(s). All in-water operations, including vessels, must be shutdown if a manatee(s) comes within 50 feet of the operation. Activities will not resume until the manatee(s) has moved beyond the 50-foot radius of the project operation, or until 30 minutes elapses if the manatee(s) has not reappeared within 50 feet of the operation. Animals must not be herded away or harassed into leaving.
- e. Any collision with or injury to a manatee shall be reported immediately to the FWC Hotline at 1-888-404-FWCC. Collision and/or injury should also be reported to the U.S. Fish and Wildlife Service in Jacksonville (1-904-232-2580) for north Florida or Vero Beach (1-561-562-3909) for south Florida.
- f. Temporary signs concerning manatees shall be posted prior to and during all in-water project activities. All signs are to be removed by the permittee upon completion of the project. Awareness signs that have already been approved for this use by the Florida Fish and Wildlife Conservation Commission (FWC) must be used. One sign measuring at least 3 ft. by 4 ft. which reads *Caution: Manatee Area* must be posted. A second sign measuring at least 8 1/2" by 11" explaining the requirements for "Idle Speed/No Wake" and the shut down of in-water operations must be posted in a location prominently visible to all personnel engaged in water-related activities.

**FWC Approved Manatee Educational Sign Suppliers**

**ASAP Signs & Designs**

624-B Pinellas Street  
Clearwater, FL 33756  
Phone: (727) 443-4878  
Fax: (727) 442-7573

**Wilderness Graphics, Inc.**

P. O. Box 1635  
Tallahassee, FL 32302  
Phone: (850) 224-6414  
Fax: (850) 561-3943  
[www.wildernessgraphics.com](http://www.wildernessgraphics.com)

**Cape Coral Signs & Designs**

1311 Del Prado Boulevard  
Cape Coral, FL 33990  
Phone: (239) 772-9992  
Fax: (239) 772-3848

**Municipal Supply & Sign Co.**

1095 Fifth Avenue, North  
P. O. Box 1765  
Naples, FL 33939-1765  
Phone: (800) 329-5366 or  
(239) 262-4639  
Fax: (239) 262-4645  
[www.municipalsigns.com](http://www.municipalsigns.com)

**Vital Signs**

104615 Overseas Highway  
Key Largo, FL 33037  
Phone: (305) 451-5133  
Fax: (305) 451-5163

**Universal Signs & Accessories**

2912 Orange Avenue  
Ft. Pierce, FL 34947  
Phone: (800) 432-0331 or  
(772) 461-0665  
Fax: (772) 461-0669

**New City Signs**

1829 28<sup>th</sup> Street North  
St. Petersburg, FL 33713  
Phone: (727) 323-7897  
Fax: (727) 323-1897

**United Rentals Highway  
Technologies**

309 Angle Road  
Ft. Pierce, FL 34947  
Phone: (772) 489-8772  
or (800) 489-8758 (FL only)  
Fax: (772) 489-8757

**CAUTION: MANATEE HABITAT**

All project vessels

**IDLE SPEED / NO WAKE**

**When a manatee is within 50 feet of work  
all in-water activities must**

**SHUT DOWN**

Report any collision or injury to:

**1-888-404-FWCC (1-888-404-3922)**

Florida Fish and Wildlife Conservation Commission

# SITE DEVELOPMENT PLANS FOR JENKINS CREEK BOAT RAMP REPLACEMENT HERNANDO, FLORIDA

KEY # 376702

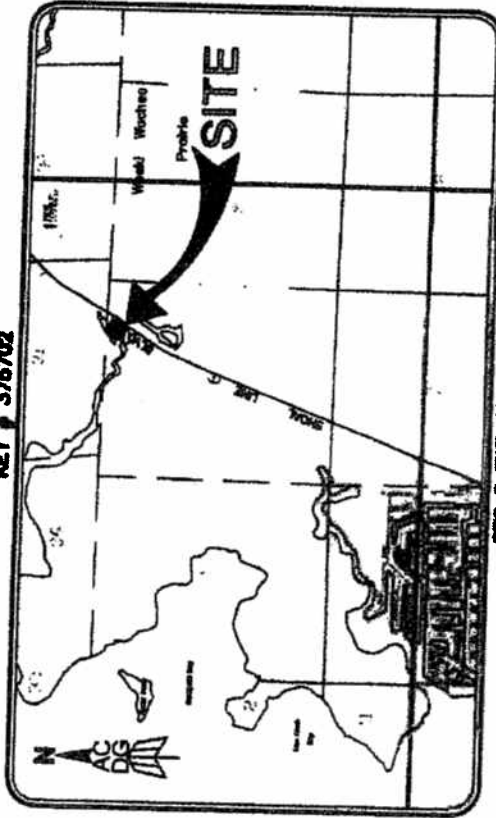

SEC 6 TWP 23S RGE 17E

## INDEX

- SHEET 1 OF 12 - COVER SHEET
- SHEET 2 OF 12 - AERIAL
- SHEET 3 OF 12 - SOILS MAP
- SHEET 4 OF 12 - QUAD
- SHEET 5 OF 12 - LOCATION MAP
- SHEET 6 OF 12 - DEMOLITION PLAN
- SHEET 7 OF 12 - SITE PLAN
- SHEET 8 OF 12 - OVERALL SITE PLAN
- SHEET 9 OF 12 - RAMP PROFILE
- SHEET 10 OF 12 - SECTIONS
- SHEET 11 OF 12 - DETAILS
- SHEET 12 OF 12 - DETAILS

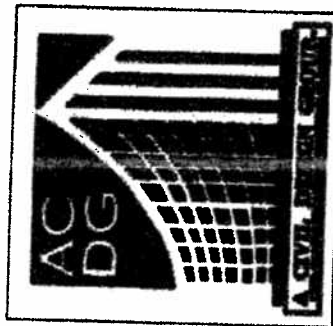

### CONTRACTOR/DEVELOPER

AL TOLER  
HERNANDO COUNTY  
PARKS & RECREATION DEPT.  
26 N. MAIN STREET, ROOM 200  
BROOKSVILLE, FL 34601  
TEL (352) 754-4458  
FAX (352) 754-4464

### SURVEYOR

JOHN A. BREARD P.S.M.  
GAS SURVEYING, L.L.C.  
1365 PONCE DE LEON BLVD.  
BROOKSVILLE, FL  
TEL (352) 799-2544  
FAX (352) 799-2546  
john.gasurvey@btinternet.com

### ENGINEER

A CIVIL DESIGN GROUP, L.L.C.  
1325 SPRING HILL DRIVE  
SPRING HILL, FL 34609  
www.acdgroup.com  
TEL (352) 683-2566  
FAX (352) 683-2567  
E# #77666

### APPROVED SET

Richard B. [Signature]  
P.E. #31316  
ACDG PROJECT # 376702

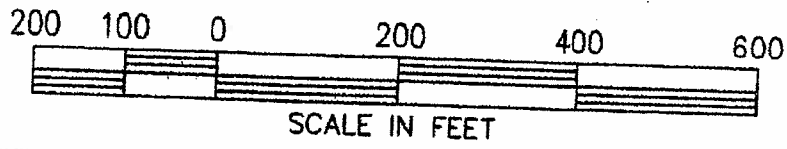

RICHARD J. MAIR  
REGISTERED PROFESSIONAL ENGINEER  
STATE OF FLORIDA  
No. 12000  
DATE

2 of 12  
SHEET NO.  
JENKINS CREEK BOAT RAMP REPLACEMENT  
HERNANDO COUNTY, FL  
AERIAL

A CIVIL DESIGN GROUP, L.L.C.  
CIVIL ENGINEERS & PLANNERS  
12529 Spring Hill Drive Spring Hill, FL, 34809  
Phone - (352) 683-8566  
WWW.ACivilDesign.com  
Registration # EB-27060



Hernando County, Florida (FL963)			
Map Unit Symbol	Map Unit Name	Acres in AOI	Percent of AOI
3	Arenas-Urbén land complex	6.0	12.1%
4	Arpoka fine sand	14.9	30.2%
26	Homestead mucky fine sandy loam	8.4	17.0%
35	Uyelda fine sand	3.6	7.4%
37	Chocoma-Terra Ceia association	4.8	9.8%
53	Weekiwachee muck	4.4	9.0%
99	Water	1.9	3.8%
100	Waters of the Gulf of Mexico	5.3	10.8%
Totals for Area of Interest		49.4	100.0%

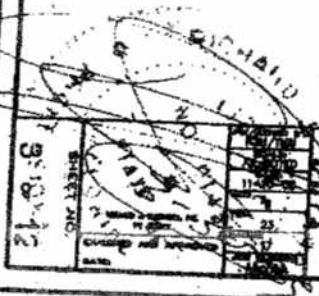
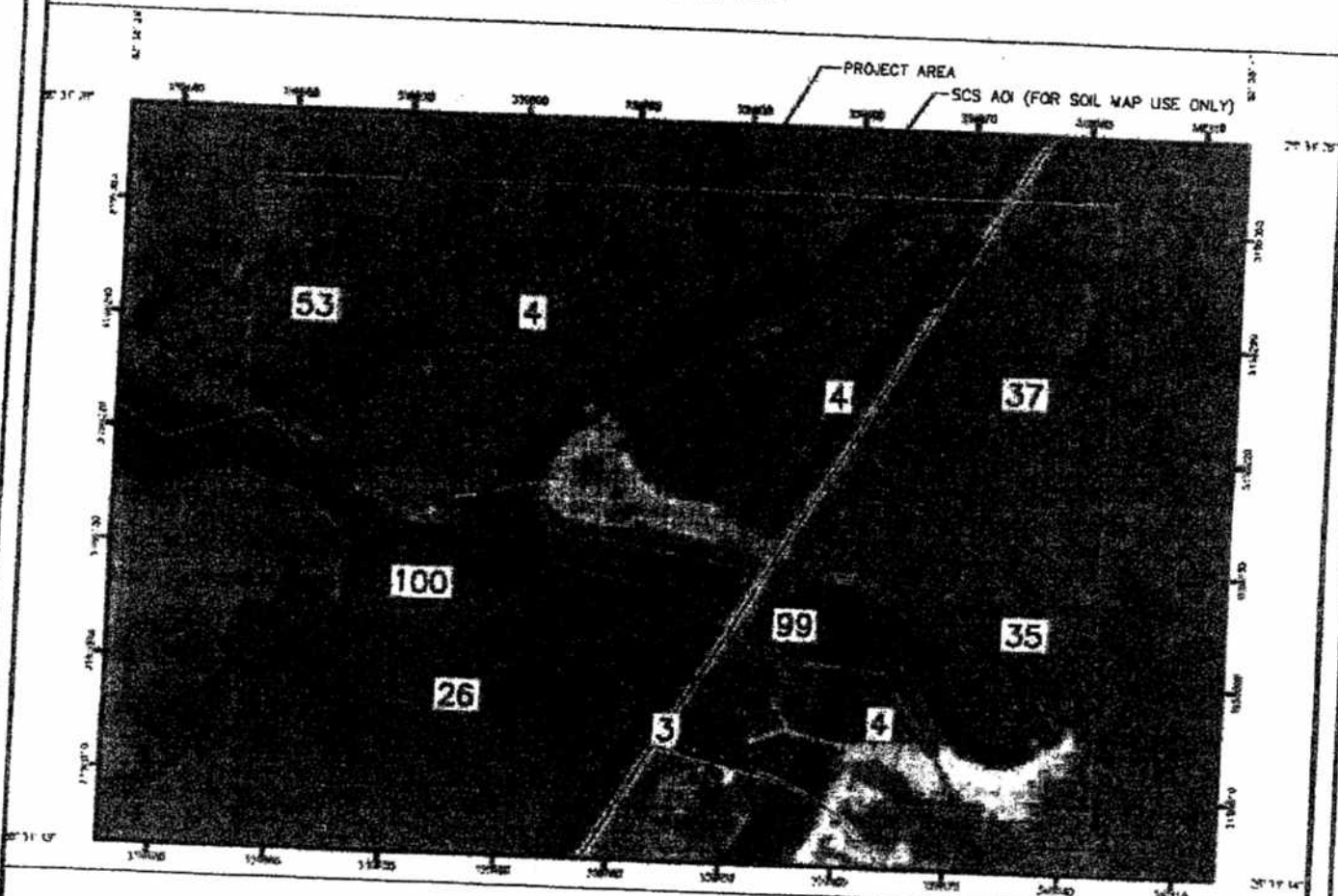
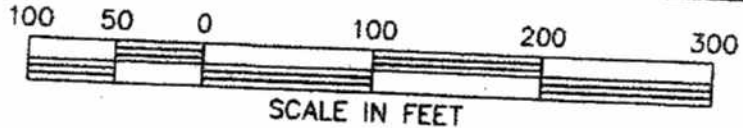

JENKINS CREEK BOAT RAMP REPLACEMENT  
 HERNANDO COUNTY, FL  
 SCS SOILS MAP

A CIVIL DESIGN GROUP, L.L.C.  
 CIVIL ENGINEERS & PLANNERS  
 12529 Spring Hill Drive Spring Hill, FL, 34809  
 Phone - (352) 883-0606  
 WWW.ACivilDesign.com  
 Registration # EB-27080



2000 1000 0 2000 4000 6000

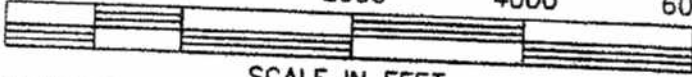

SCALE IN FEET

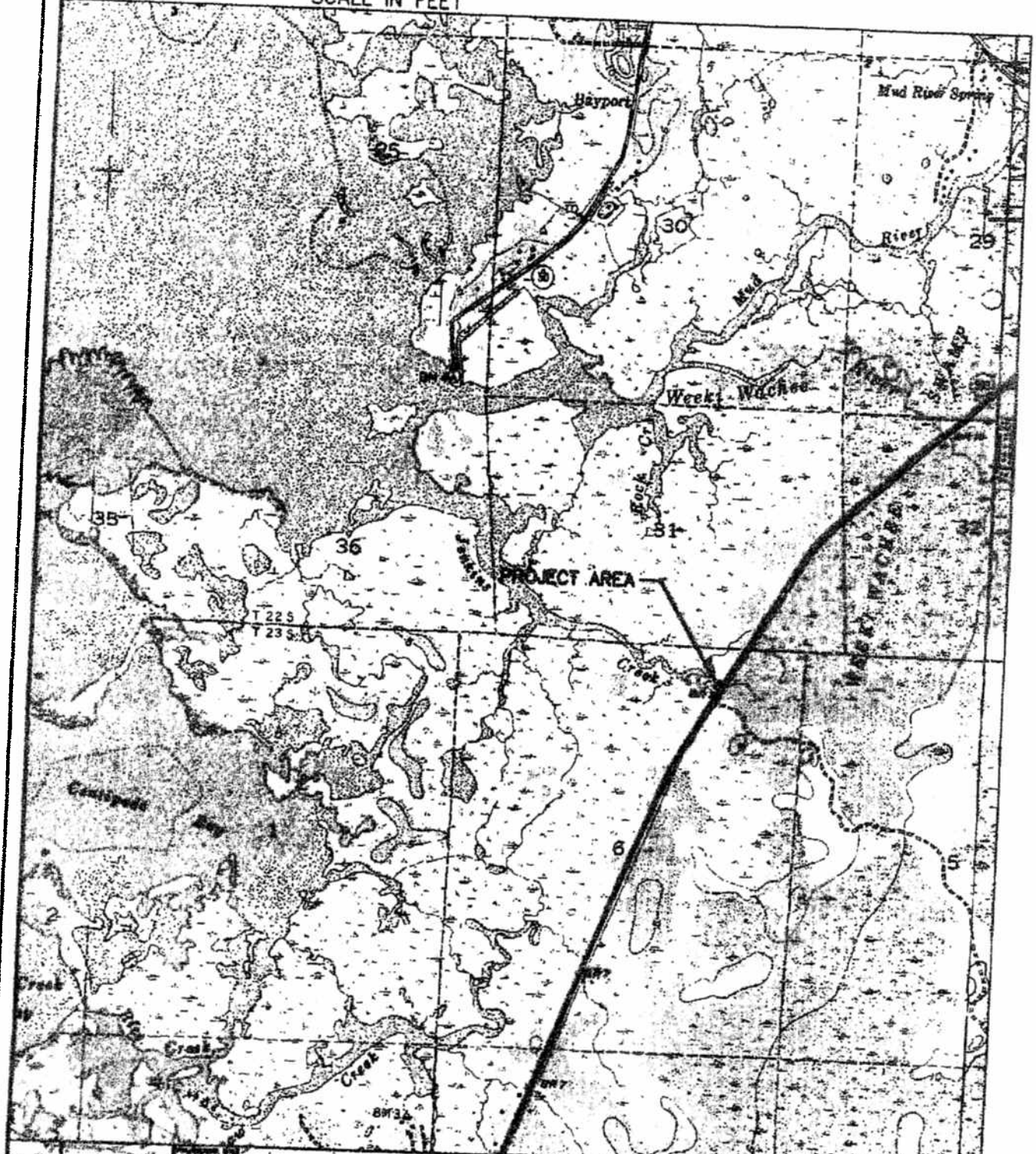

JENKINS CREEK BOAT RAMP REPLACEMENT

HERNANDO COUNTY, FL

USGS QUAD

A CIVIL DESIGN GROUP, L.L.C.  
CIVIL ENGINEERS & PLANNERS  
12625 Spring Hill Drive Spring Hill, FL 34608  
Phone - (352) 683-6666  
WWW.ACivilDesign.com  
Registration # EB-27080



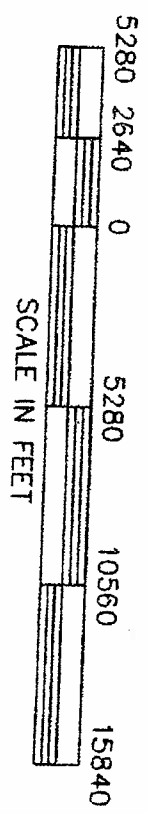
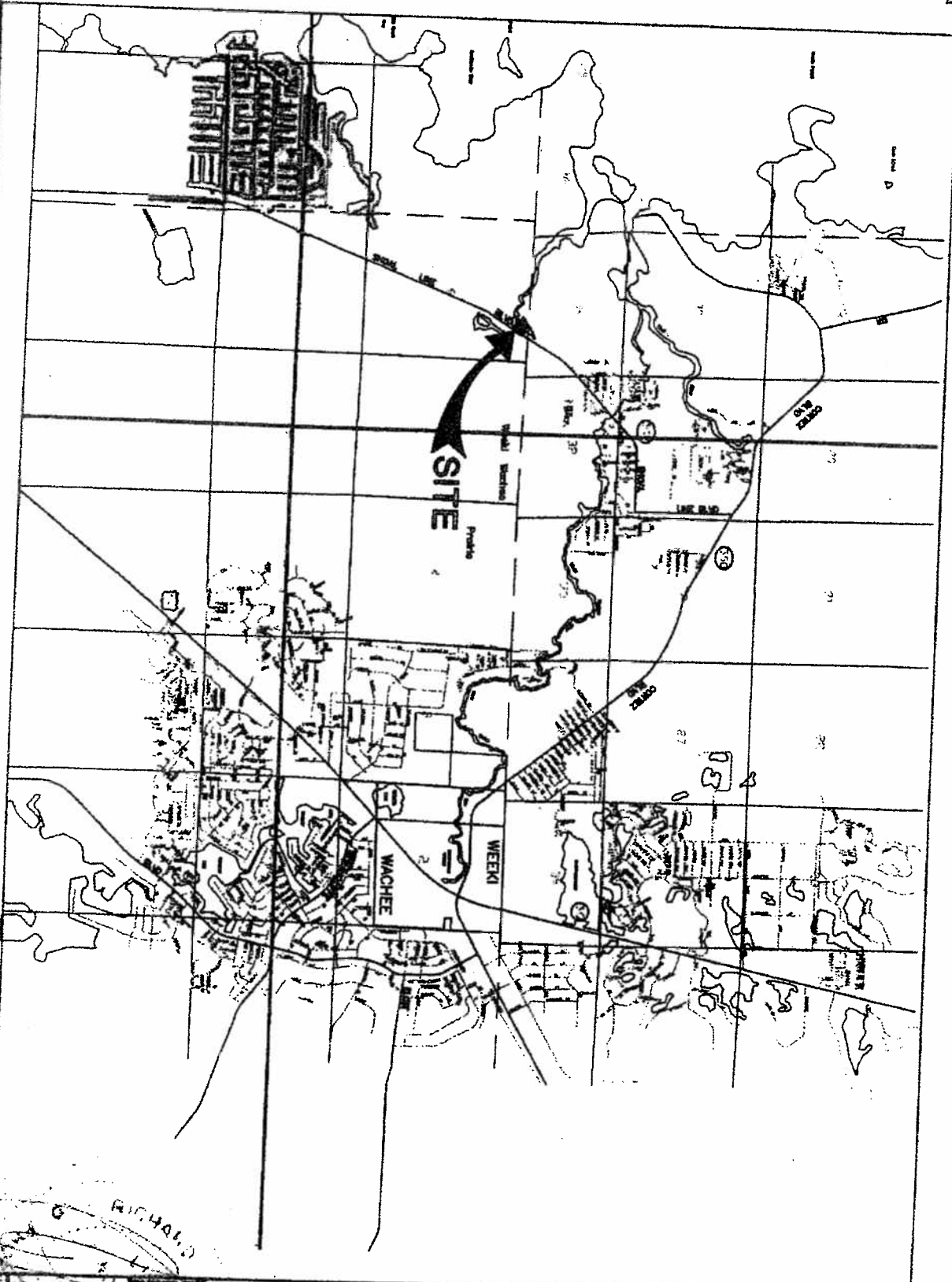

SHEET NO. 5 OF 12

JENKINS CREEK BOAT RAMP REPLACEMENT  
HERNANDO COUNTY, FL  
LOCATION MAP

A CIVIL DESIGN GROUP, L.L.C.  
CIVIL ENGINEERS & PLANNERS  
12529 Spring Hill Drive Spring Hill, FL, 34609  
Phone - (352) 683-9588  
WWW.ACivilDesign.com  
Registration # EB-27060





SCALE IN FEET



- SPECIAL NOTES:**
1. NO FILLING SHALL BE PERFORMED OTHER THAN THAT REQUIRED TO LEVEL SURFACE UNDER PROPOSED RAMP.
  2. NO DREDGING SHALL BE PERFORMED OTHER THAN THAT REQUIRED TO PREPARE AREA UNDER PROPOSED RAMP OR HEADWALL.
  3. DURABLE SILT FENCE AROUND STOCKPILE AREA SHALL BE INSTALLED PRIOR TO COMMENCEMENT OF CONSTRUCTION AND SHALL BE MAINTAINED SO THAT NO SPOIL MATERIAL CAN ESCAPE INTO WETLANDS OR SURFACE WATERS. SPOILS SHALL BE REMOVED TO OTHER COUNTY PARK PROPERTIES IMMEDIATELY UPON COMPLETION OF DEWATERING FOR FUTURE USE ON COUNTY PARK UPLANDS.

SIGN  
"NO RAMP - SILE SPEED"

MEAN HIGH WATER ELEVATION 2.0'

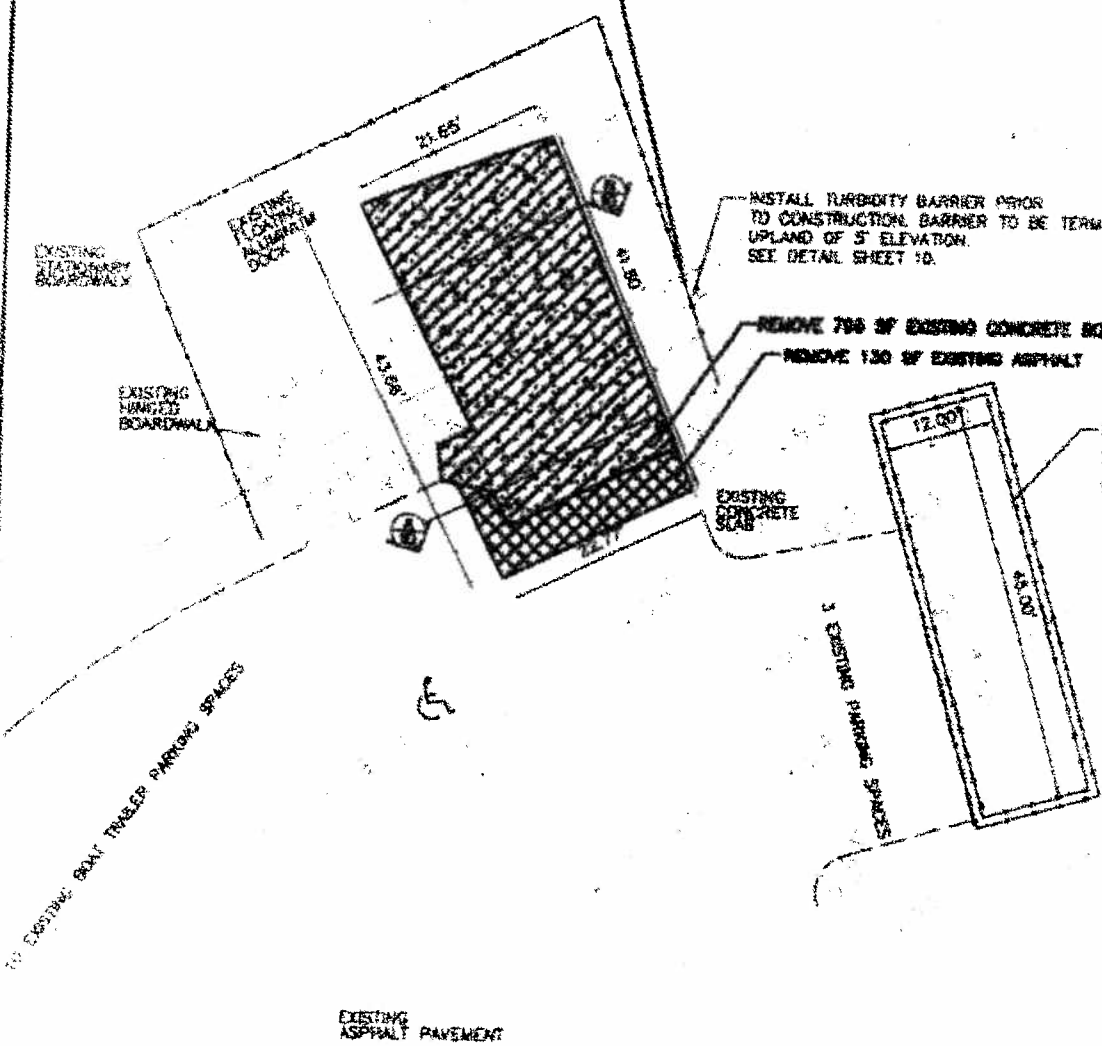

6 of 12	DATE: 10/12/11	PROJECT: JENKINS CREEK BOAT RAMP REPLACEMENT
	DRAWN BY: [Signature]	CHECKED BY: [Signature]

**JENKINS CREEK BOAT RAMP REPLACEMENT**  
**HERNANDO COUNTY, FL**  
**DEMOLITION PLAN**

**A CIVIL DESIGN GROUP, L.L.C.**  
 CIVIL ENGINEERS & PLANNERS  
 12529 Spring Hill Drive Spring Hill, FL 34481  
 Phone: (352) 683-0566  
 WWW.ACivilDesign.com  
 Registration # EB-27060



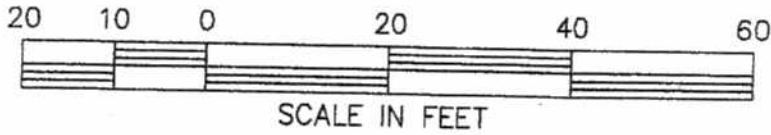

- SPECIAL NOTES:**
1. NO FILLING SHALL BE PERFORMED OTHER THAN THAT REQUIRED TO LEVEL SURFACE UNDER PROPOSED RAMP.
  2. NO DREDGING SHALL BE PERFORMED OTHER THAN THAT REQUIRED TO PREPARE AREA UNDER PROPOSED RAMP OR HEADWALL.
  3. DOUBLE SILT FENCE AROUND STOCKPILE AREA SHALL BE INSTALLED PRIOR TO COMMENCEMENT OF CONSTRUCTION AND SHALL BE MAINTAINED SO THAT NO SPOIL MATERIAL CAN ESCAPE INTO WETLANDS OR SURFACE WATERS. SPOILS SHALL BE REMOVED TO OTHER COUNTY PARK PROPERTIES IMMEDIATELY UPON COMPLETION OF DEWATERING FOR FUTURE USE ON COUNTY PARK UPLANDS.

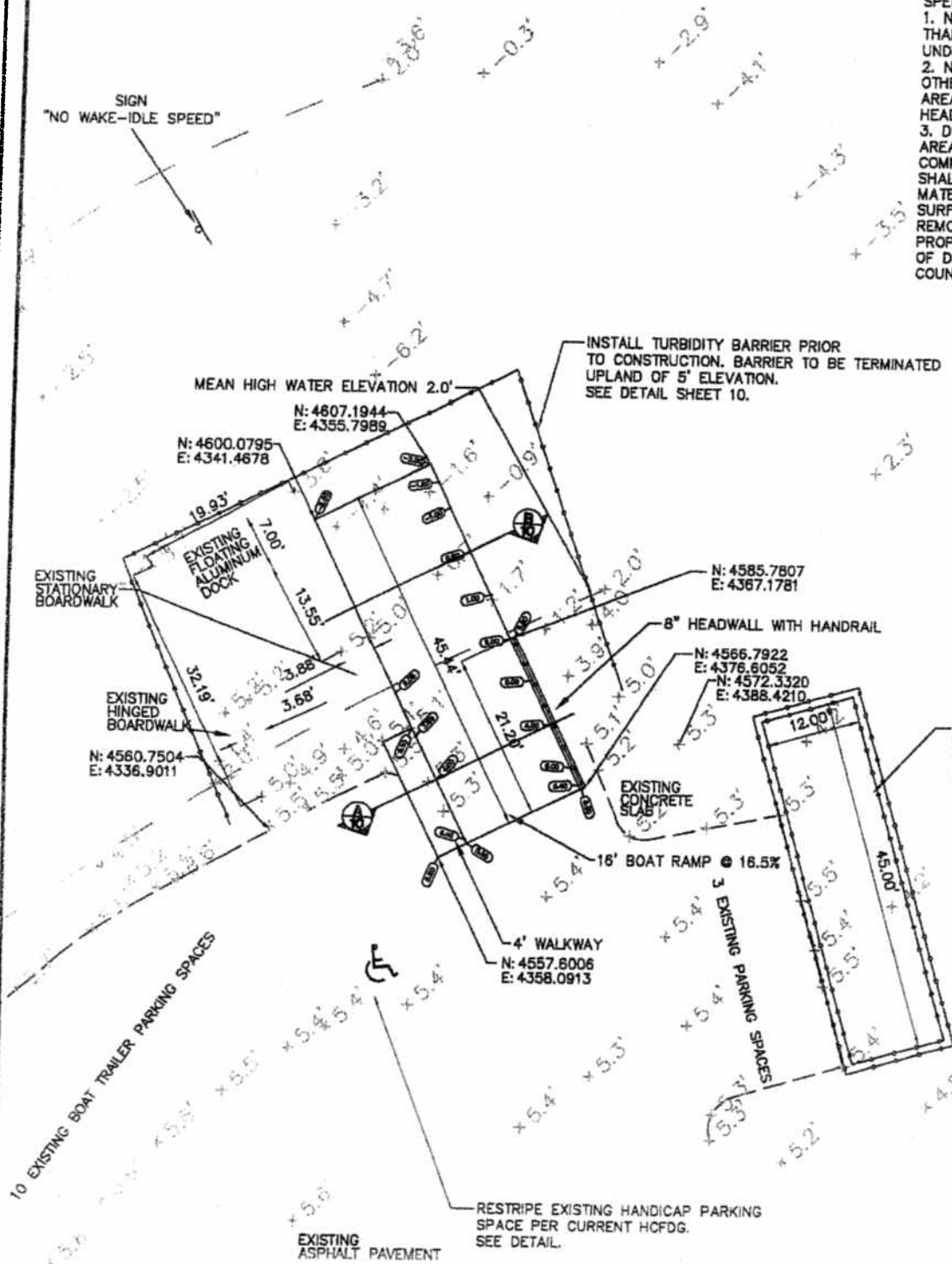

7 OF 12	SHEET NO.	PL/DRW/ BY	AS NOTED
		DATE	11-19-08
REVIEW & APPROVE		DATE	12-17-08
DATE		JOB NUMBER	080081

**JENKINS CREEK BOAT RAMP REPLACEMENT**  
**HERNANDO COUNTY, FL**  
**SITE PLAN**

**A CIVIL DESIGN GROUP, L.L.C.**  
 CIVIL ENGINEERS & PLANNERS  
 12529 Spring Hill Drive Spring Hill, FL, 34809  
 Phone - (352) 683-8566  
 WWW.ACivilDesign.com  
 Registration # EB-27080



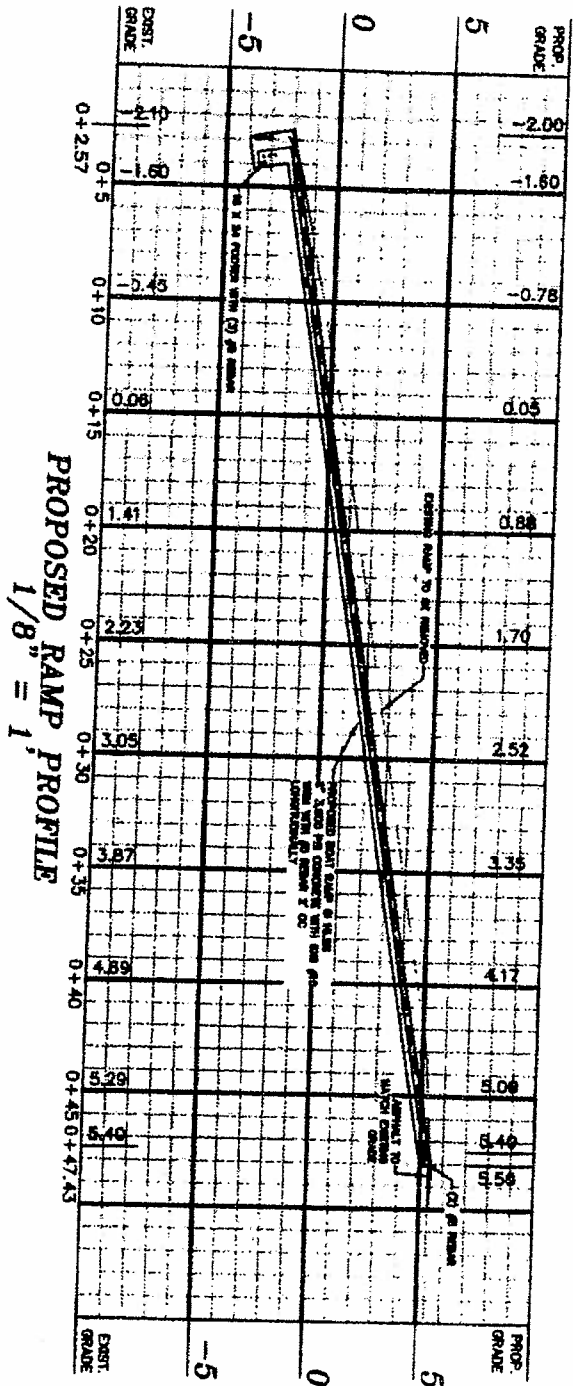

PROPOSED RAMP PROFILE  
 $1/8" = 1'$

RICHARDSON  
 9 12

JENKINS CREEK BOAT RAMP REPLACEMENT  
 HERNANDO COUNTY, FL  
 RAMP PROFILE

A CIVIL DESIGN GROUP, L.L.C.  
 CIVIL ENGINEERS & PLANNERS  
 12529 Spring Hill Drive Spring Hill, FL, 34609  
 Phone - (352) 683-9566  
 WWW.ACivilDesign.com  
 Registration # EB-27060



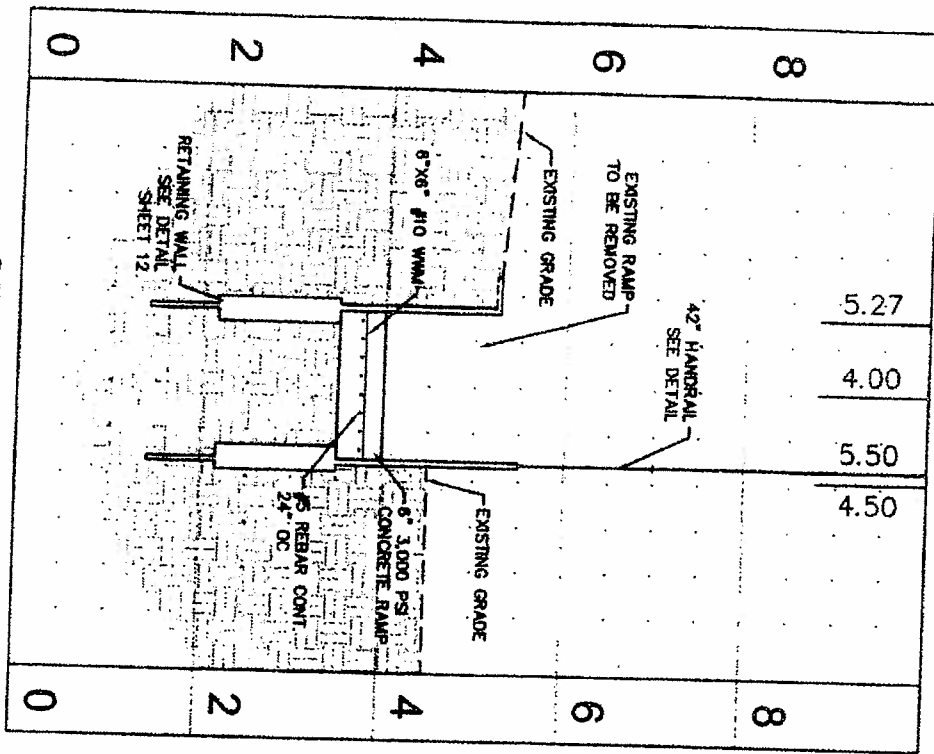

**SECTION A**  
 SCALE: HORIZ. 1" = 20'  
 VERT. 1" = 2'

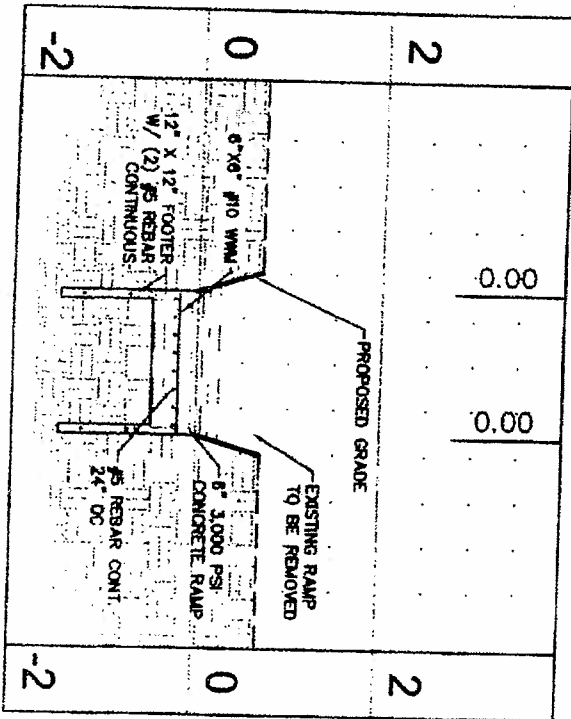

**SECTION B**  
 SCALE: HORIZ. 1" = 20'  
 VERT. 1" = 2'

10 of 12

JENKINS CREEK BOAT RAMP REPLACEMENT

HERNANDO COUNTY, FL

**SECTIONS**

A CIVIL DESIGN GROUP, L.L.C.

CIVIL ENGINEERS & PLANNERS

12528 Spring Hill Drive Spring Hill, FL 34609

Phone - (352) 883-9568

WWW.ACivilDesign.com

Registration # EB-27060



# TIDAL WATERS AND/OR HEAVY WIND AND WAVE ACTION

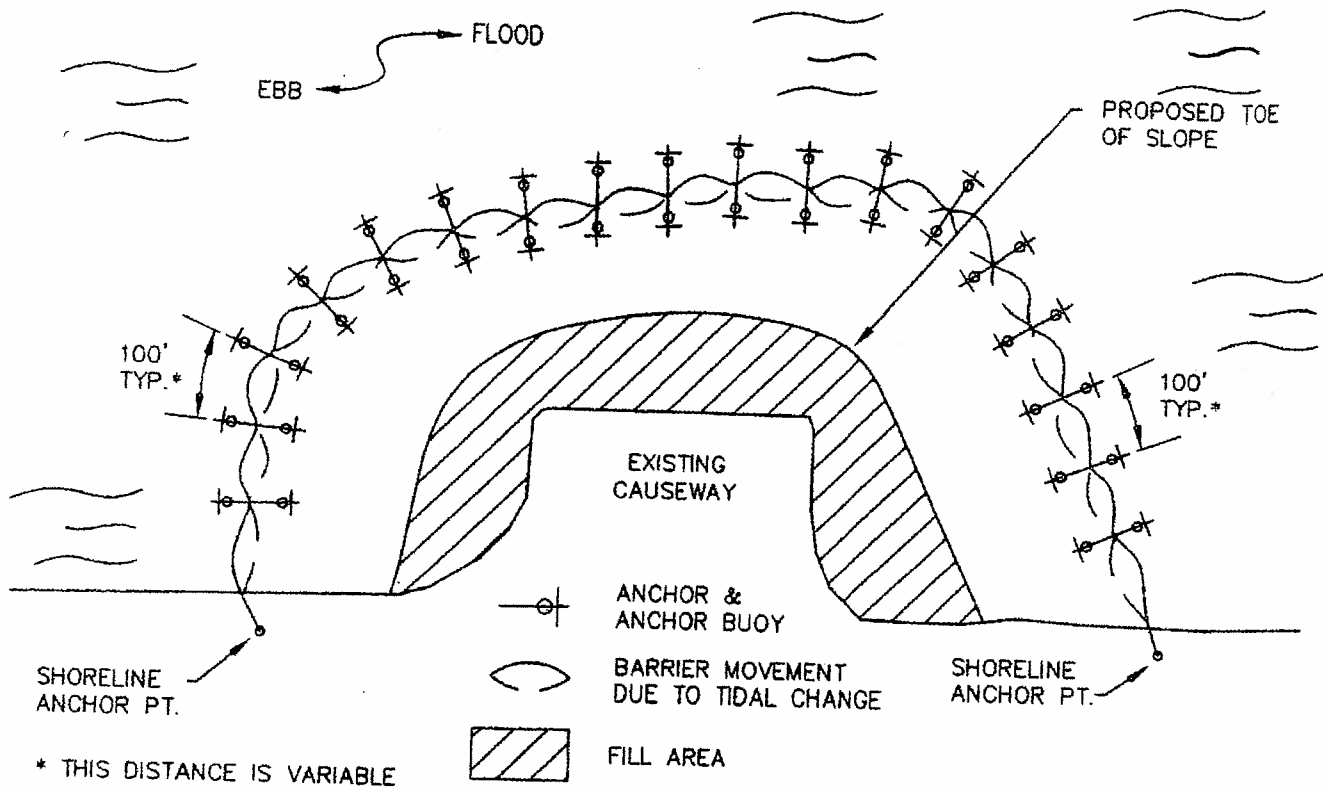

**TURBIDITY BARRIER INSTALLATION DETAIL**  
N.T.S.

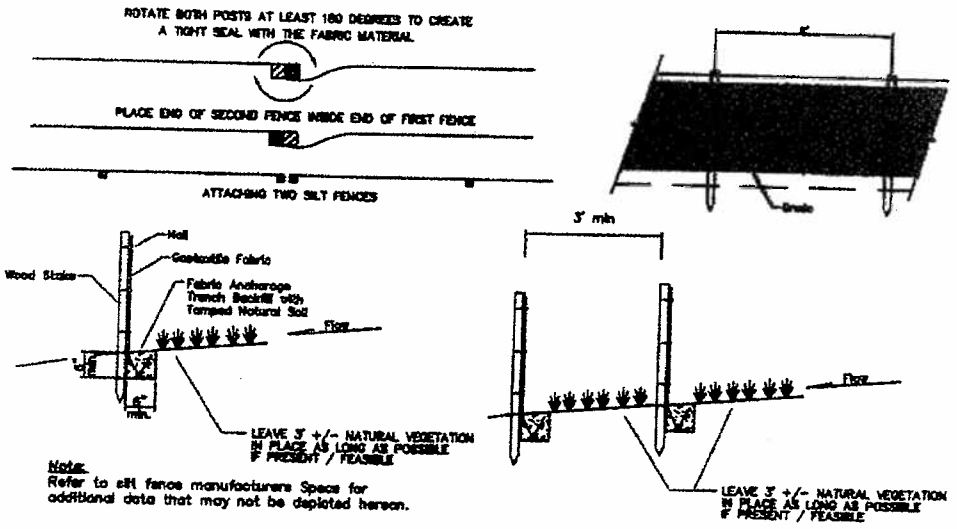

**SILT FENCE INSTALLATION DETAIL**  
N.T.S.

17 of 12

11/11/12

11/11/12

11/11/12

11/11/12

JENKINS CREEK BOAT RAMP REPLACEMENT  
HERNANDO COUNTY, FL  
**DETAILS**

A CIVIL DESIGN GROUP, L.L.C.  
CIVIL ENGINEERS & PLANNERS  
12529 Spring Hill Drive Spring Hill, FL, 34609  
Phone - (352) 883-9568  
WWW.ACivilDesign.com  
Registration # EB-27060



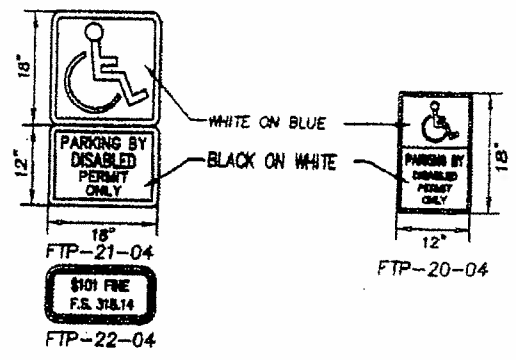
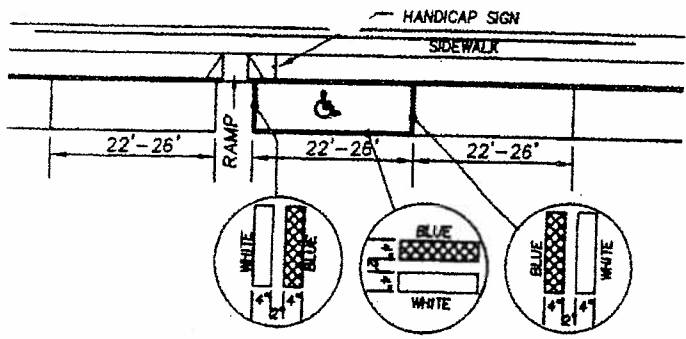

- All parking space lines to be 4" wide and white unless otherwise noted.
- Use of pavement symbol in handicapped parking spaces is optional, but when used shall be 3 ft. to 5 ft. high and white in color.
- The access aisle shall be striped diagonally to designate it as a no parking zone, and shall be white in color. Curb ramps must be located outside of disabled parking spaces and access aisles.

(Signs erected after October 1, 1996, must indicate penalty for illegal use of the space)

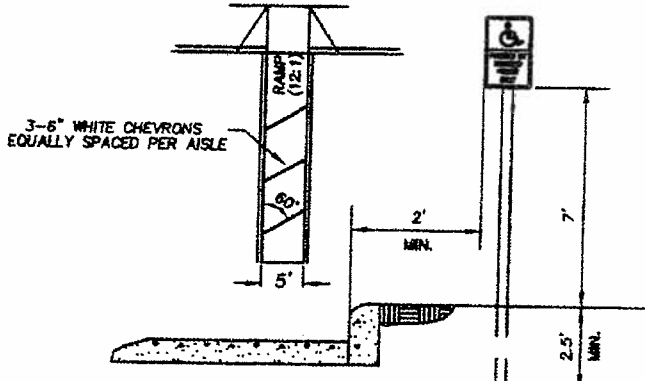
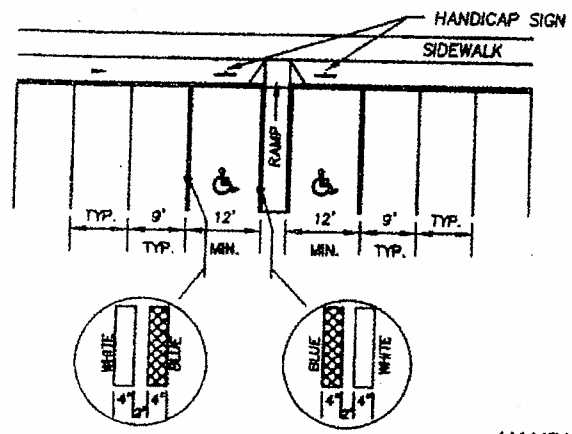

- Handicap sign(s) may be affixed on permanent structure in lieu of installing on poles.

**HANDICAP PARKING DETAIL**  
N.T.S.

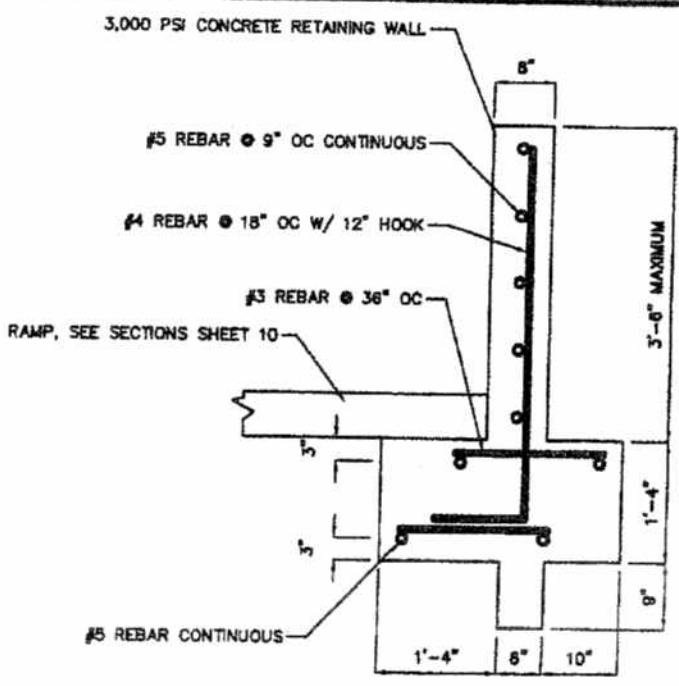

**RETAINING WALL DETAIL**  
N.T.S.

12 of 12  
REVISIONS  
NO. DESCRIPTION  
1  
2  
3  
4  
5  
6  
7  
8  
9  
10  
11  
12

**JENKINS CREEK BOAT RAMP REPLACEMENT**  
HERNANDO COUNTY, FL  
**DETAILS**

**A CIVIL DESIGN GROUP, L.L.C.**  
CIVIL ENGINEERS & PLANNERS  
12529 Spring Hill Drive Spring Hill, FL 34609  
Phone - (352) 883-9566  
WWW.ACivilDesign.com  
Registration # EB-27360

