

HERNANDO COUNTY SPECIAL EXCEPTION USE PERMIT PETITION
Application for Public Hearing

Date: 1-9-04

Print or Type all information. Refer to instruction sheets for assistance or call the Planning Department at the number on the instruction sheet.

APPLICANT: <u>SAMUEL STOKES</u>	
Mailing Address: <u>1070 CADDWELL ST. BROOKSVILLE, FL 34602</u>	
Daytime Phone: <u>848-0535</u>	FAX No.: <u>—</u>
REPRESENTATIVE: <u>JAMES H. LENOX</u>	
Mailing Address: <u>25079 FADETTA DR, BROOKSVILLE, FL 34601</u>	
Daytime Phone: <u>790-0246</u>	FAX No.: <u>799-6111</u>
PUBLIC CONTACT PERSON: <u>SAME</u>	
Daytime Phone: _____ FAX No.: _____	
CONDUCT AT PUBLIC HEARINGS:	
Will Expert Witness be utilized during the public hearings? <u>NO</u>	
Please indicate how much additional time will be required during the public hearing (see instruction sheet): <u>15 MIN.</u>	
Legal Description: Write below the complete legal description of the property. Include Section, Township and Range; and if applicable, Subdivision Name, Lot, Block, and Unit Number. Attach additional sheet if necessary. <u>SW 1/2 OF NW 1/2 SECT. 25, TOWNSHIP 23 SOUTH, RANGE 20 EAST AND EAST 1/2 ACRE IN SOUTH 1/2 NW 1/4 OF NW 1/4 OF SECT. 35, TOWNSHIP 23 S. RANGE 20 OF HERNANDO CO, FL</u> SEC _____ TWP _____ (S) RANGE _____ (E)	
Size of Area Covered by Application: <u>4.2 ACRES</u>	
Highway & Street Boundaries: <u>CADDWELL ST. OFF OF CHURCH ST.</u>	
Current Zoning Classification: <u>AP-2</u>	
Special Exception Requested: <u>CHURCH</u>	
Has a public hearing been held on this property within the past twelve months? <u>NO</u>	
ACKNOWLEDGMENT	
This acknowledgment must be signed in the presence of a Notary Public.	
<u>STOKES, SAMUEL</u> , hereby state and affirm that I have read the instructions for filing this application and that:	
<input checked="" type="checkbox"/> I am the owner of the property covered under this application. <input type="checkbox"/> I am the legal representative of the owner or lessee of the property described, which is the subject matter of the application.	
All answers to the questions in said application, all sketches and data attached to and made part of this application are honest and true to the best of my knowledge and belief. <u>Stokes Samuel</u> Signature of Applicant or Representative	
STATE OF FLORIDA _____	COUNTY OF HERNANDO _____
On this the <u>3</u> day of <u>FEB</u> , 20 <u>04</u> , before me, the undersigned Notary Public of the State of Florida, personally appeared <u>SAMUEL STOKES</u> and whose name(s) is/are subscribed to the within instrument, and acknowledge that he/she/they executed it.	
WITNESS my hand and official seal. <u>Robert O. Amison</u> Notary Signature	<div style="border: 1px solid black; padding: 5px; display: inline-block;"> OFFICIAL NOTARY SEAL ROBERT O AMISON NOTARY PUBLIC STATE OF FLORIDA COMMISSION NO. DD060524 MY COMMISSION EXP. SEPT 26, 2005 </div> NOTARY SEAL & COMMISSION EXPIRATION:
The individual(s) are <input type="checkbox"/> personally known to me or, <input checked="" type="checkbox"/> presented the following identification: <u>FL DL# S322-297-24-134-0</u>	

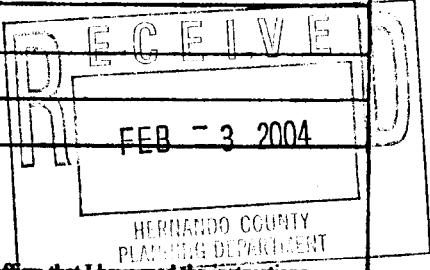

JAMES HAL LENOX - ARCHITECT
25079 FADETTE DRIVE
BROOKSVILLE FLORIDA 34601
352 796-0246 FAX 352 799-6111
FL REG NO AR - 0011916

2-01-04

MR. CHRIS MITLER – PLANNER
HERNANDO CO. PLANNING DEPT.
BROOKSVILLE , FL.

RE: SPECIAL USE PERMIT – STOKES PROPERTY
CARDWELL ST.
HERNANDO COUNTY

DEAR MR. MITLER,

PER THE REQUIREMENTS OF THE APPLICATION FOR SPECIAL PERMIT, I AM WRITING THIS LETTER TO DESCRIBE THE DETAILS CONCERNING THE ABOVE REF. PROPERTY OF PASTOR SAM STOKES. THE PROPERTY OWNED BY MR. STOKES IS APPROXIMATELY 4.2 ACRES AND IS CURRENTLY ZONED 'AR-2'. IT HAS A SINGLE-FAMILY RESIDENCE THAT IS APPROXIMATELY 30 % COMPLETE WITHIN ITS BOUNDARIES. THIS STRUCTURE WAS PERMITTED IN 1988 AND WAS NEVER FINISHED.

THE PLAN IS TO COMPLY WITH ALL HERNANDO COUNTY REQUIREMENTS, ADD APPROXIMATELY 250 SF TO THE AS-BUILT TOTAL OF 3100 SF, AND CONVERT THE SPACE TO A NEW CHURCH. PARKING WILL BE PROVIDED FOR 12 CARS AND THE ESTIMATED CAPACITY WILL BE 20 -30 PEOPLE. THE STRUCTURE IS CBS AND HAS A CONCRETE FOUNDATION. THERE IS NO ROOF ON THE STRUCTURE. I HAVE INCLUDED THE REQUIRED **SITE PLAN** AND ALSO AN '**AS-BUILT PLAN**' OF THE BUILDING. ALSO INCLUDED IS A **FRONT ELEVATION AND PROPOSED FLOOR PLAN**.

THE FACILITY WILL HAVE LOW IMPACT ON THE AREA AND CHURCH ROAD. SERVICES WILL BE HELD ONCE DAILY ON SUNDAY, SATURDAY, AND WEDNESDAY. THE APPROXIMATE TIME FOR THESE MEETINGS WILL BE 10 AM – 3 PM. THE ESTIMATED ATTENDANCE WILL BE SMALL AT FIRST WITH 10-20 PEOPLE , BUT THE ATTENDANCE MIGHT RISE IN THE FUTURE TO 30 PEOPLE. THE DINING ROOM WILL BE USED AS NEEDED. THE ESTIMATED ATTENDANCE OF THE DINING ROOM WILL BE 10-15 PEOPLE POSSIBLY ONCE OR TWICE A WEEK. MOST OF THE ATTENDEES LIVE WITHIN A 3 MILE RADIUS OF THE PROPERTY AND CAR POOLING WILL BE COMMON.

THE PROPERTY HAS AN EXISTING MOBILE HOME ADJACENT TO THE PROPOSED CHURCH. THIS WILL BE USED FOR STORAGE OF FOOD RELATED ITEMS , CHAIRS , AND MISCELLANEOUS CHURCH ITEMS.

I HOPE THE BOARD WILL CONSIDER THE REQUEST FAVORABLY AND GRANT PASTOR STOKES HIS DREAM. AS STATED , THIS IS A VERY LOW IMPACT FACILITY THAT CAN BE VERY BENEFICIAL TO THE COMMUNITY. IF THERE ARE ANY QUESTIONS AND OR CLARIFICATIONS , PLEASE CALL ME.

SINCERELY,

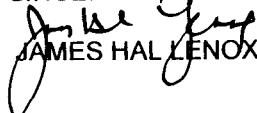
JAMES HAL LENOX - ARCHITECT

Minister Samuel Stokes

1070 CARDWELL STREET
BROOKSVILLE, FLORIDA 34602
TELEPHONE (352) 848-0535

I have been a Minister of the Gospel for ten years. I have never accepted any payment for delivering the Word of God. If I do receive a love offering for this ministry, I immediately return it back to the church. It was God that called me to do this ministry. I receive the word freely through the power of the Holy Ghost, and freely I deliver it to a lost and dying world.

I know the Lord called me into this ministry, and as long as God bestows His power and His strength upon me to preach the word, I will expound it freely to a world of lost sinners! God's word says in Matthew 10:8 - freely ye have received, freely give.

With God's help, I will help the lost that are willing to receive help. God's word says in Matthew 10:14-16 And whosoever shall not receive you, nor hear your words, when ye depart out of the house or city, shake off the dust of your feet. Verily I say unto you, It shall be more tolerable for the land of Sodom and Gomorrha in the day of judgment, than for that city. Behold, I send you forth as sheep in the midst of wolves: be ye therefore wise as serpents, and harmless as doves.

Crucified with Christ,

Minister of the Gospel
Samuel Stokes

New Life In Christ Church Of God

Samuel Stokes, Founder & Overseer
352-848-0535

1070 Cardwell St
Brooksville, Fl
34602

Greetings in the name of our Lord and Saviour Jesus Christ. As Founder of this organization I want to inform you to what this Mission is all about.

First

we do all things for the edifying of Jesus Christ. " For though I preach the gospel, I have nothing to glory of; for necessity is laid upon me; yea, woe is unto me, if I preach not the gospel! For if I do this willingly , I have a reward; but if against my will, a dispensation of the gospel is committed unto me.

What is my reward then? Verily that, when I preach the gospel, I may make the gospel of Christ without charge, that I abuse not my power in the gospel. For though I be free from all *men*, yet have I made myself servant unto all, that I might gain the more". 1 Corinthians 9:16-19.

Everyone in this ministry is a volunteer, and looking to Jesus for their reward.

God has freely given us these gifts and they will be freely used as directed by the Holy Spirit, because we are indebted to the Lord. We are to see about His people which is the lost, needed, sick, afflicted, druggist, alcohol etc. this

is our responsibility.

For further information please feel free to call me at 352-848-0535

Your Brother In Christ,
Minister Samuel Stokes

The small scale of the following document may not be legible with some electronic viewers. The full-size version of this document and all file documents may be viewed at the Hernando County Planning Department during 8:00 AM to 5:00 PM, Monday thru Friday. If you have any questions, please contact us at 352-754-4057. Thank you.

REDUCED COPY, NOT TO SCALE

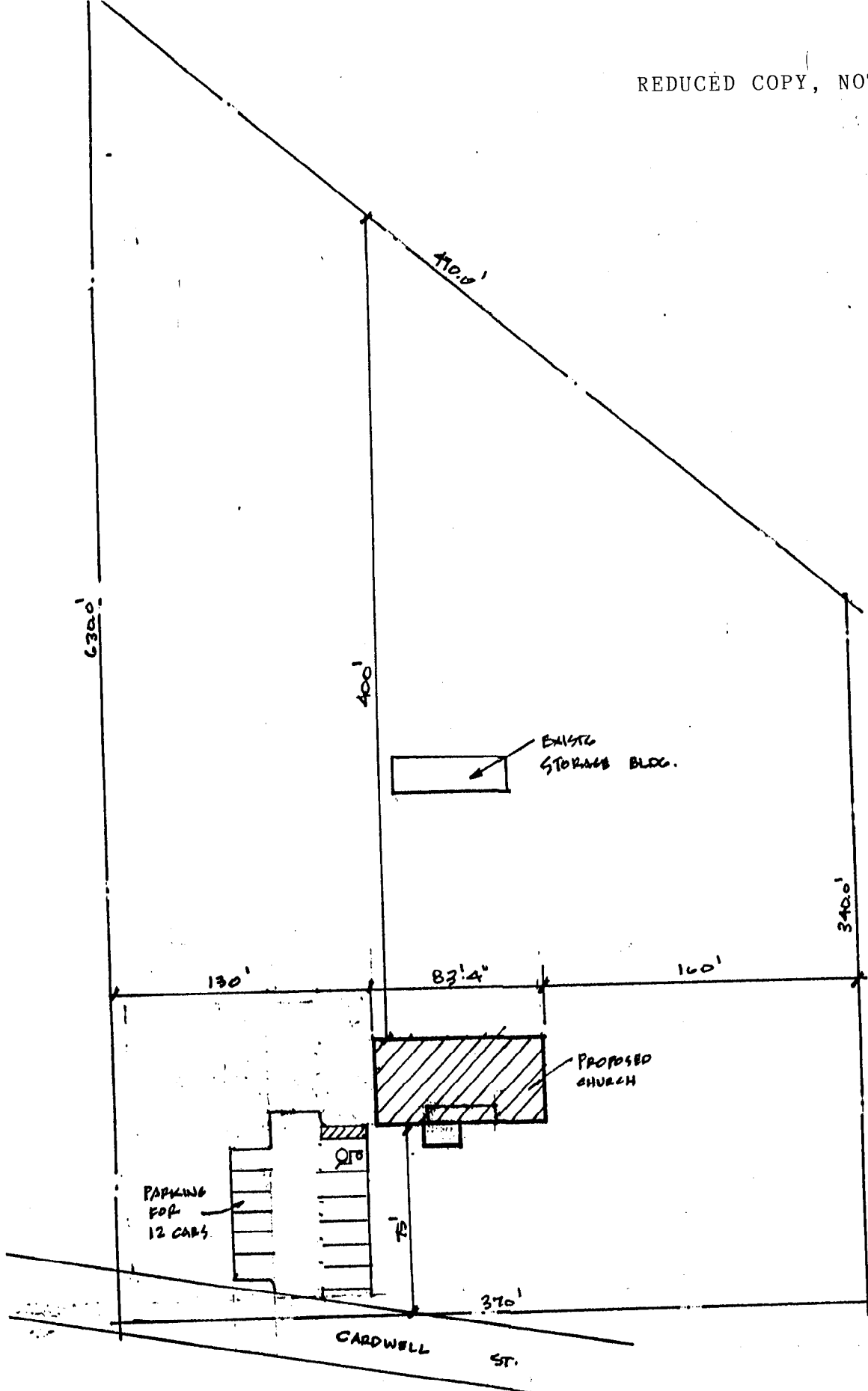

SITE PLAN
1"=60'

