

**HERNANDO COUNTY CONDITIONAL USE PERMIT PETITION**  
**Application for Public Hearing**

Date: 8-10-03

Print or Type all information. Refer to instruction sheets for assistance or call the Planning Department at the number on the instruction sheet.

**APPLICANT:** Nyia Sue Moore

Mailing Address: 3475 Charmwood Ave Spring Hill, FL 34609

Daytime Phone: (352) 686-3270 OR (352) 442-1446 FAX No.: N/A

**REPRESENTATIVE:** SELF OR MARVIN MOORE

Mailing Address: 3475 Charmwood Ave, Spring Hill, FL 34609

Daytime Phone: (352) 686-3270 OR (562) 553-4132 FAX No.: N/A

**PUBLIC CONTACT PERSON:** Nyia Sue Moore

Daytime Phone: (352) 686-3270 FAX No.: N/A

**CONDUCT AT PUBLIC HEARINGS:** Nyia Sue Moore

Will Expert Witness be utilized during the public hearings? No

Please indicate how much additional time will be required during the public hearing (see instruction sheet): NONE

**Legal Description:** Write below the complete legal description of the property. Include Section, Township and Range; and if applicable, Subdivision Name, Lot, Block, and Unit Number. Attach additional sheet if necessary. COMMERCIAL PROPERTY TRACT 71 ELPICO AN UN-RECORDED SUBDIVISION, FURTHER DESCRIBED AS FOLLOWS: THE EAST 1/2 OF THE EAST 1/2 OF THE SE 1/4 OF THE SE 1/4 OF SECTION 36 SEC 36 TWP 23 (S) RANGE 17 (E)

Size of Area Covered by Application: Bldg. is 8'x10' parking 20'x30' = total 28'x30'

Highway & Street Boundaries: COUNTY LINE ROAD

Current Zoning Classification: C1

Reason for Conditional Use Permit: SHAVED ICE - ICE CREAM - SMOOTHIES

Length of Time Requested for Use: 3 YEARS

Has a public hearing been held on this property within the past twelve months? No

**ACKNOWLEDGMENT**

This acknowledgment must be signed in the presence of a Notary Public.

I, Nyia Sue Moore, hereby state and affirm that I have read the instructions for filing this application and that:

AUTHORIZED BY PROPERTY OWNER  
 I am the owner of the property covered under this application.

I am the legal representative of the owner or lessee of the property described, which is the subject matter of the application.

All answers to the questions in said application, all sketches and data attached to and made part of this application are honest and true to the best of my knowledge and belief.

Nyia Sue Moore  
Signature of Applicant or Representative

STATE OF FLORIDA \_\_\_\_\_ COUNTY OF HERNANDO

On this the 19<sup>th</sup> day of August, 20 03, before me, the undersigned Notary Public of the State of Florida, personally appeared Nyia Sue Moore and whose name(s) is/are subscribed to the within instrument, and acknowledge that he/she/they executed it.

WITNESS my hand and official seal.

Faith E. Koch  
Notary Signature

The individual(s) are  personally known to me or,  presented the following identification: \_\_\_\_\_

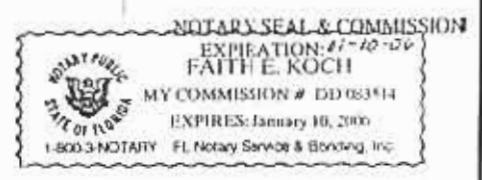

## SHAVED ICE

This building is a portable building, outside measuring in size 8 x 10 and is fully self contained coded for 50 states, with water, hot water heater, holding tank. It is a very nice building, custom made for its purpose. It has white vinyl and trimmed in red (serving trays, back door and metal roof) and has about \$1,000 worth of neon lighting.

In addition to shaved ice we would like to serve soft serve ice cream and smoothies.

We have had this business in operation in Indiana in the past, and had opened during summer months, we did this for 4 years.

It is a family owned operation and we do the work ourselves. The business operations time will be approx. 12:00 p.m. until 9:00 p.m., depending on the weather and will be open 6 days aweek, closed on Mondays.

The building itself takes up approx. 1 parking space, there are at least 7 parking spaces during the time of 12:00 p.m. and an additional 8 parking spaces after 6:00 p.m. The strip mall behind where the building is proposed to set is vacant.

ALL 10 ACRES AND BUILDINGS OWNED  
By ELLOW & PAULINE BUSH

TOTAL 10 ACRES

ADDRESS

10207 County Line Rd  
Spring Hill Florida

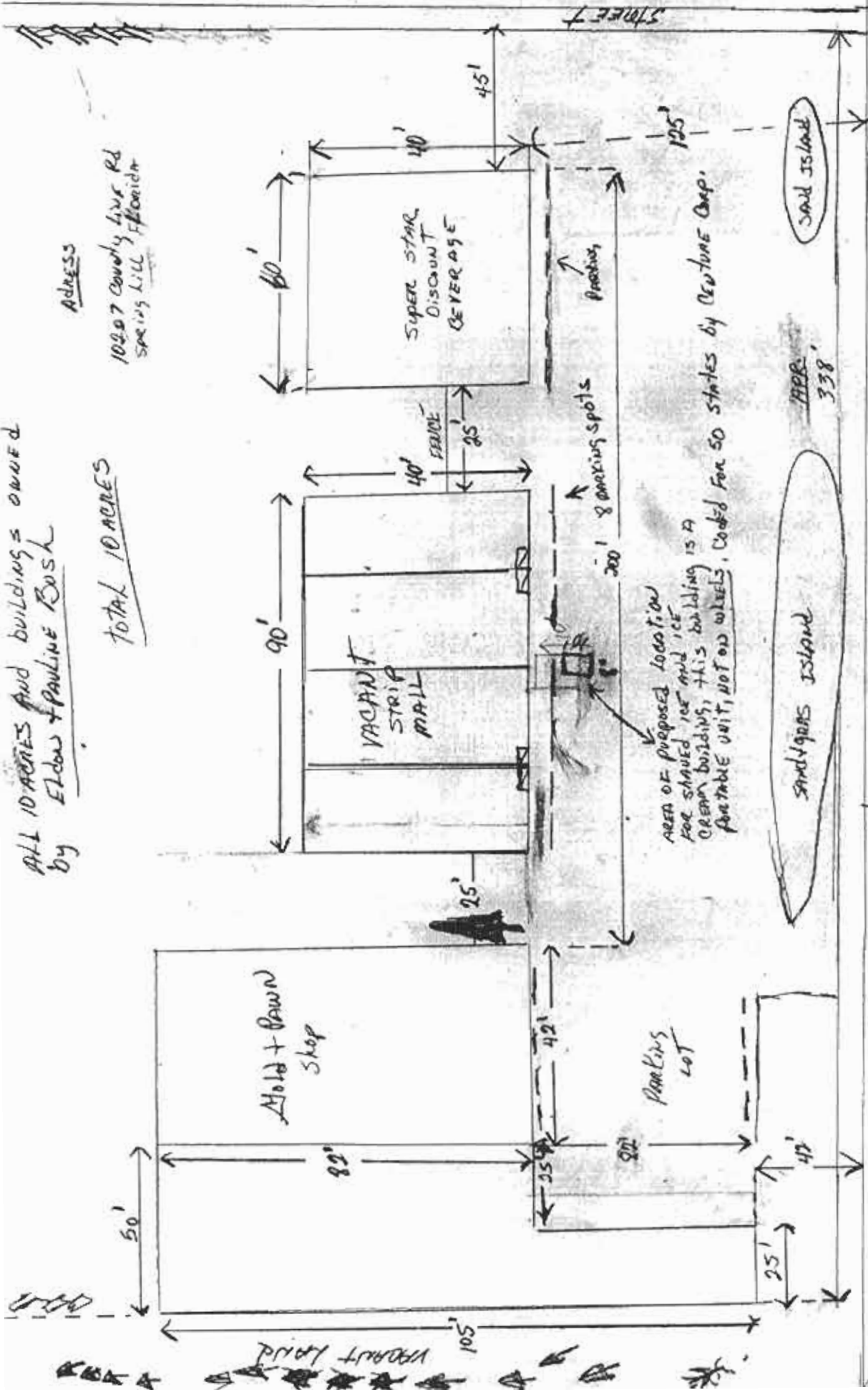

AREA OF PROPOSED LOCATION FOR SHAVED ICE AND ICE CREAM BUILDING, THIS BUILDING IS A PORTABLE UNIT, NOT ON WHEELS, CODED FOR 50 STATES BY CENTURE CORP.

SAND ISLAND

SAND ISLAND

APN 338

COUNTY LINE Rd