

Residential Buildout Ratio of Infill Subdivisions* in Spring Hill

Refuse Collection MSBU
 Spring Hill Subdivision

* 10 or more platted lots
 1/1/2009 Tax Roll

Improved Lots/Platted Lots

1. Wedgwood Estates 12/14
2. Primrose Lane 66/71
3. Bridgewater 192/192
4. Village of Hope 22/22
5. Sutton Place 24/25
6. Horizon North 66/71
7. Pearl Estates 6/14
8. Storybook Estates 1/14
9. West Linden Estates 91/96
10. Topics 231/231
11. Huntington Woods 49/53
12. Linden Retreat 24/29
13. Silver Hills 33/63
14. Sunhill 43/53
15. Brookview Villas 50/50
16. Tangerine Estates 295/478
17. Zirkels Estate 19/29

PAGE 49

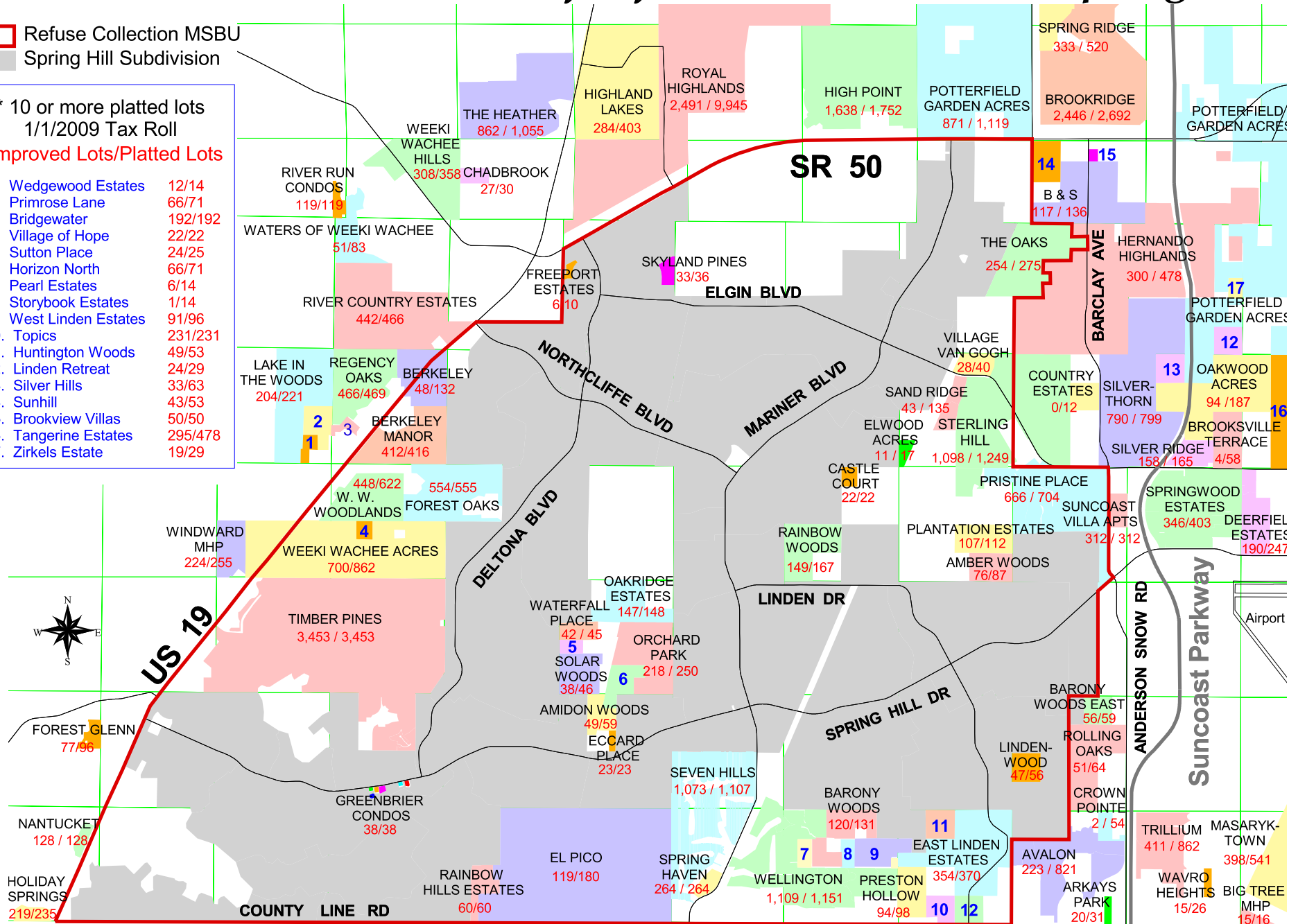

0 2 4 Miles